

PART INFORMATION

No : 017/IAMI/INV/III/2009

Tanggal : 13 Maret 2009

Perihal : REVISI PART CATALOG TBR541 & PART INFO NO.013/PM/INV/VI/2008 (20 JUNI 2008).

FIG NO : 4-36 POWER STEERING CONTROL; ENGINE SIDE

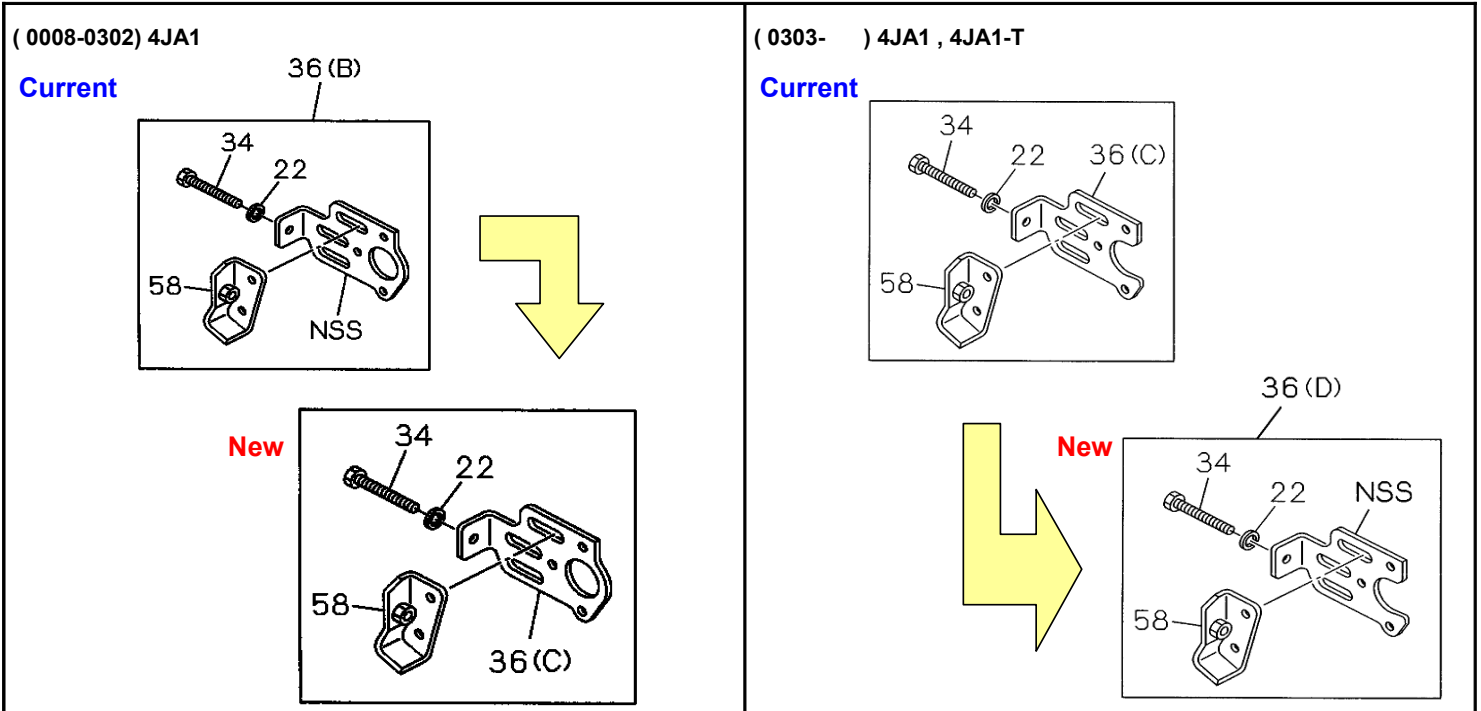

NO	PART NUMBER	DESCRIPTION	FIG NO	KEY NO	APPLIED DATE	TYPE	REMARKS
1	9-09150 510-0	WASHER; LK, OIL PUMP, P/S	4-36	22	0008-0611	4JA1	ID=10,2
2	9-09150 510-0	WASHER; LK, OIL PUMP, P/S	4-36	22	0612-	4JA1-T	ID=10,2 EURO 2
3	0-20801 070-0	BOLT; ADJ PLATE	4-36	34	0008-0611	4JA1	POWER STEERING<N40>, M10X70
4	0-20801 070-0	BOLT; ADJ PLATE	4-36	34	0612-	4JA1-T	POWER STEERING<N40>, M10X70 EURO 2
5	8-97066 758-1	BRACKET; PLATE, P/S PUMP	4-36	36	0008-0302	4JA1	(B) CAN NOT SUPPLY BY ASM (SUPERSEDED TO 8-97066 759-1)
6	8-97066 759-1	BRACKET; PLATE, P/S PUMP	4-36	36	0303-	4JA1	(C) IND , NOT ITC
7	8-97562 167-A	BRACKET; PLATE, P/S PUMP	4-36	36	0303-0611	4JA1	(D) IND
8	8-97562 167-A	BRACKET; PLATE, P/S PUMP	4-36	36	0612-	4JA1-T	(D) EURO 2
9	8-94479 122-0	SLIDER; BELT ADJ, P/S OIL	4-36	58	0008-0611	4JA1	POWER STEERING<N40>
10	8-94479 122-0	SLIDER; BELT ADJ, P/S OIL	4-36	58	0612-	4JA1-T	POWER STEERING<N40> EURO 2